

Visiline 2 Slimline Sliding Door

An avant-garde design of a thermally broken sliding system that permits maximum luminosity with the minimum amount of seen aluminium profile section. An elegance in design that looks to cover great light spaces with minimum frame fragments from 8% of the total surface. It shows seen centre junction sections of only 20 mm, in the lateral junction at 50 mm and the top/bottom junctions at 50 mm.

Manufactured in the UK.

Possibility of sash meetings at a 90° corner without a mullion.

In its monochannel version, comprising of fixed and sash, the hidden rail is found in the fixed area.

It incorporates the new type of **GALANDAGE** that is designed to allow the possibility of an integral opening in the space to completely conceal the sashes in the building curtain wall chamber. In this way a 100% opening surface can be achieved.

This **GALANDAGE** option is made up of a single and dual channel rail which allows for a single or double sash concealed balcony doors.

This presents a new type of frame for 1, 2 or 3 rails that allows the incorporation of a stainless steel rail that affords increased sliding smoothness, an increase in loading support for the bearings (up to 600 kg/sash) and increased durability.

A system with traditional fitting procedures with perimetral frame and sashes that allows the sash to be dismantled in case of glass breakage, damage to the aluminium profile etc. It incorporates an electric shootbolt lock.



Visiline 2 Slimline Sliding Door

Transmittance

Uw from 1,2 (W/m²K)

Please consult typology, dimensions and glass

Acoustic insulation

Maximum glazing: 52 mm

Maximum acoustic insulation **Rw = 41 dBA**

Categories achieved at test centre

Air permeability
(EN 12207): Class 4

Water tightness
(EN 12208): Class 7A

Wind resistance
(EN 12210): Class C5
Reference test 1,23 x 1,55 m. 1 sash + 1 fixed light

Finishes

RAL9005
RAL7016
RAL7021
Platinum Anodized



Sections

Frame 150mm 2 rails
225mm 3 rails
Mullion 20mm

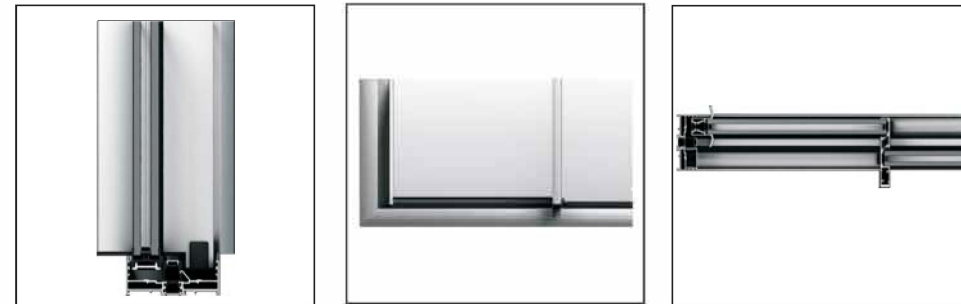
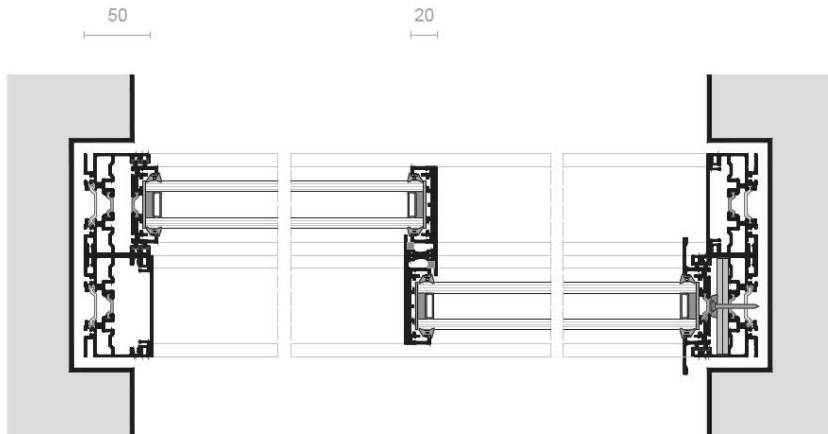

Opening possibilities



Maximum dimensions/sash

Width (L) = 4200 mm
Height (H) = 3200 mm

Consult maximum weight and dimensions according to typologies

Maximum weight/sash

600 Kg